

PROPERTY ACQUISITION			
PCL.	RECORD OWNER AS OF DATE	AREA (ACRES) GROSS	AREA (ACRES) NET
A	MORENO, A. L. & L. M. F. ROBERTS, CO.	1.304	0.964
B	TANAKA, F. & S. K.	0.181	0.076
C	TRI-VALLEY DEV. INC.	0.112	0.065
D	HORE LUTHERAN CHURCH OF S. C.	0.202	0.165
E	O'CONNOR, TR. & V.	0.292	0.184
G	CALIF. PACIFIC TITLE INSUR. CO.	0.011	0.011
H	TITLE INSURANCE & TRUST CO.	0.011	0.011

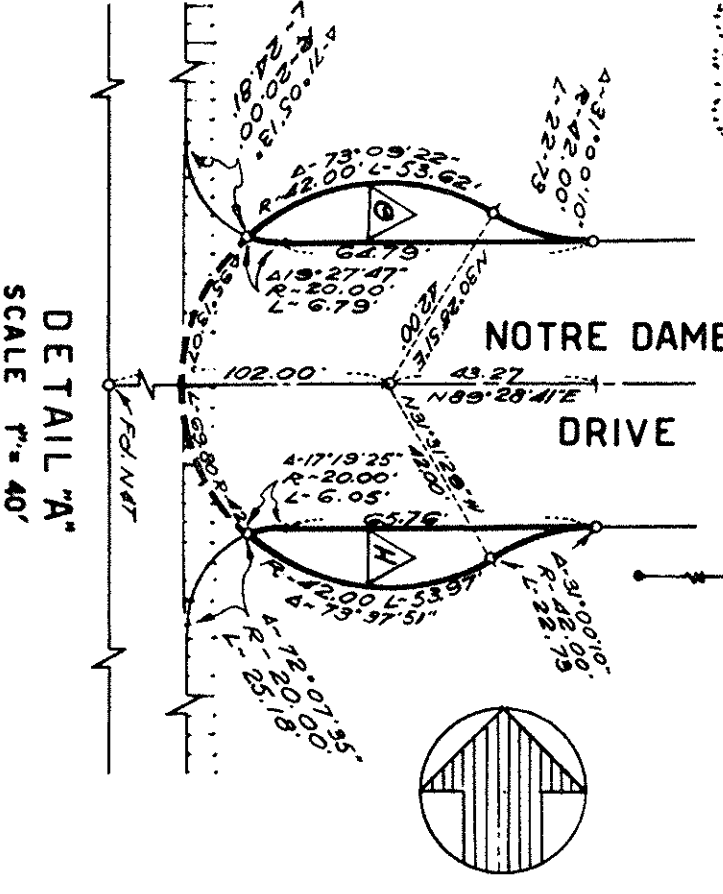

RECORDER'S CERTIFICATE
File No. 2335597
Filed for record this 25th day of JANUARY 1963, at 11:07 A.M. in Book 156 of Maps, of page 34, at the request of The Board of Supervisors of the County of Santa Clara.

PAUL A. TELLEZ
County Recorder
By Deputy James T. Pott

LEGEND
..... INDICATES 3/4" IRON PIPE SET OR AS NOTED.
..... INDICATES 3/4" IRON PIPE FOUND OR AS NOTED.
===== INSIDE CITY LIMITS LINE.
===== ACCESS PROHIBITED

NOTES
ALL MOVEMENTS NOTED AS BEING SET HAVE BEEN OR WILL BE SET PRIOR TO COMPLETION OF CONSTRUCTION OF LAURENCE EXPRESSWAY.

SURVEYOR'S CERTIFICATE
This map correctly represents a survey made by me or under my direction in conformance with the requirements of Chapter 15 of Division 3 of the Business and Professions Code of the State of California, and I am a duly Licensed Professional Surveyor of the County of Santa Clara.

JAMES T. POTT
County Surveyor
By Deputy James T. Pott

CO. SURVEYOR'S CERTIFICATE
This map has been examined for conformance with the requirements of Chapter 15 of Division 3 of the Business and Professions Code of the State of California, and I am a duly Licensed Professional Surveyor of the County of Santa Clara.

JAMES T. POTT
County Surveyor
By Deputy James T. Pott

NON-SUBDIVISION CERTIFICATE
This is to certify that this record of survey does not constitute a subdivision of land as defined under Section 11535 of the Business and Professions Code of the State of California, nor under Section 1212.1 of the Ordinance Code of the County of Santa Clara for the reason that any division of land shown herein is not for the purpose of sale or lease by the County of Santa Clara whether immediate or future. Any division of land shown herein is for the express purpose of describing rights of way for the acquisition and construction of county highways.

SANTA CLARA COUNTY, CALIFORNIA
SCALE: 1" = 50'

RECORD OF SURVEY
LAWRENCE EXPRESSWAY
BEING A PORTION OF SECTION 32, T6S, R.1W, MDBLM AND LYING WITHIN THE CITIES OF SUNNYVALE AND SANTA CLARA

PREPARED BY
CREEGAN AND D'ANGELO
CIVIL ENGINEERS
C & D DWG. NO. 6222-1