

RECORD OF SURVEY - BOUNDARY LINE ADJUSTMENT
 FOR ROGER ROOT AND JACQUELINE ROOT AND THE JAMES AND BABETTE HOVEY LIVING TRUST
 BEING PARCELS 101 AND 102 OF PINE ACRES UNIT NO. 6 PER 1-S-27
 ALSO BEING A PORTION OF THE SW 1/4 OF SECTION 14, T.6N., R.12E., M.D.M.
 AMADOR COUNTY, CALIFORNIA

SCALE: 1" = 50'

JANUARY, 2005

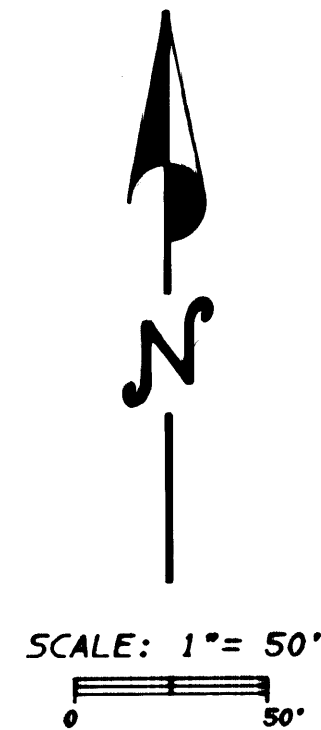

100
MACIAS
1998 007901

89
COSTA
1994 004206

88
YAKESH
658-O.R.-054

87
LACOSTE
1998 011849

KERR
1999 008661

103A
CRICKMER TRUST
1998 005988

43-M-70

103B
JACOBS
1998 012508

85
STULTS
2000 009732

OWNER'S STATEMENT

THE UNDERSIGNED BEING THE OWNERS OF THE PROPERTY DELINEATED HEREON DO HEREBY CONSENT TO THE PREPARATION AND RECORDATION OF THIS MAP.

Roger Root
Jacqueline Root
James L. Hovey
Babette C. Hovey

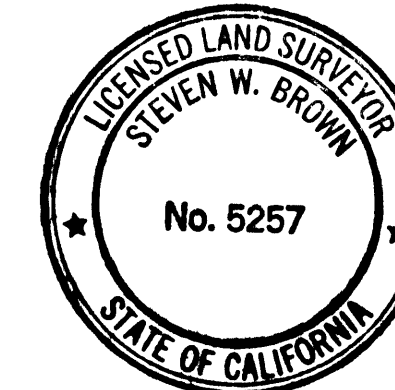

SURVEYOR'S STATEMENT

THIS MAP CORRECTLY REPRESENTS A SURVEY MADE BY ME OR UNDER MY DIRECTION IN CONFORMANCE WITH THE REQUIREMENTS OF THE PROFESSIONAL LAND SURVEYORS ACT AT THE REQUEST OF ROGER ROOT IN JANUARY, 2005.

Steven W. Brown
 STEVEN W. BROWN L.S. 5257
 LIC. EXP. 12-31-05



COUNTY SURVEYOR'S STATEMENT

THIS MAP HAS BEEN EXAMINED IN ACCORDANCE WITH SECTION 8766 OF THE PROFESSIONAL LAND SURVEYORS ACT THIS 29TH DAY OF APRIL 2005.

George E. Allen
 GEORGE E. ALLEN L.S. 4951
 LIC. EXP. 12-31-05



COMPLIANCE CERTIFICATE

THIS BOUNDARY LINE ADJUSTMENT IS IN COMPLIANCE WITH THE PROVISIONS OF THE SUBDIVISION MAP ACT, DIVISION 2 OF TITLE 7 OF THE GOVERNMENT CODE, AND ANY APPLICABLE ORDINANCE ENACTED PURSUANT THERETO.

THIS ADJUSTMENT MUST BE COMPLETED IN ALL ASPECTS BY THE 16TH DAY OF DECEMBER, 2005. THE EXCHANGE OF DEEDS OR COMPLIANCE CERTIFICATES MUST BE RECORDED BEFORE THE ABOVE DATE, PER ORDINANCE No. 1445, CHAPTER 17.89 OF THE AMADOR COUNTY CODE.

George E. Allen
 GEORGE E. ALLEN L.S. 4951
 AMADOR COUNTY SURVEYOR
 LIC. EXP. 12-31-05

NOTES & LEGEND

- SET 5/8" REBAR WITH CAP STAMPED L.S. 5257
 - FOUND 1/2" REBAR TAGGED L.S. 2902 PER 1-S-29
 - ⊕ FOUND 5/8" REBAR TAGGED L.S. 3570 PER 43-M-70
 - () RECORD DATA PER 1-S-29
 - (()) RECORD DATA PER 43-M-70
- THE BASIS OF BEARINGS AS SHOWN HEREON IS PER 1-S-29

RECORDER'S STATEMENT

FILED THIS 25TH DAY OF APRIL 2005 AT 10:54 A.M.
 IN BOOK 57 OF MAPS AND PLATS AT PAGE 74 AT THE
 REQUEST OF THE AMADOR COUNTY SURVEYOR. Doc. # 2005-0004930

Sheldon D. Johnson
 SHELDON D. JOHNSON
 AMADOR COUNTY RECORDER Fee: \$ 10.⁰⁰ pd. filed

STEVEN W. BROWN - LAND SURVEYING
 27 MAIN ST. JACKSON, CA. 95642 (209)223-1061

SCALE: 1" = 50' V.O. 3459 JANUARY, 2005

57 M 74